

## DIRECTIONS TO THE SITE

From I-69N or S – Exit at M78 (Butterfield Hwy) (Exit 48). Take M78 West towards Bellevue. At the stop light, turn left to continue on M78 W. In about 1.2 miles turn left on River Rd. Farm is about 1.7 miles on the left.

## HOTELS

Check pet policies and restrictions before reserving rooms. Some may have changed or have a limit in dogs.

### Battle Creek - I94

Red Roof Inn, 5050 Beckley Rd, Battle Creek 937-328-1821

### Marshall – I94 and I69

Hampton Inn, 325 Sam Hill Dr, Marshall  
Holiday Inn Express 329 Sam Hill Dr Marshall  
Howard's Motel 14884 W Michigan Ave, Marshall

### Charlotte

America's Best Value Inn, 828 E Shepherd St, Charlotte

### Lansing

Red Roof Inn Lansing West 7412 W Saginaw Hwy Lansing

## CAMPING

Permitted on site. Dry Camping only. No hookups, no water, no electricity. Please take your trash with you.

### Alternate Camping with Full Hookups

Camp Turkeyville RV Resort, 18935 15 1/2 Mile Rd, Marshall, MI 49068

## EMERGENCY VETERINARIAN

Greater Lansing Veterinary Center  
1290 W Grand River Ave Suite 500, Williamston, MI 48895 517-708-2525

## ENTRANCE TO THE FIELD, PARKING AND CAMPING



Entrance to the field is an easement under the electric towers. Parking is along the tree line to the south and east. Please keep a drivable lane. Please contact the FTS if you plan on camping.

## PREMIUM LIST

Early entries close on Wednesday, June 26, 2024 at 9:00 PM  
Gate entries close on the day of the event at 10:00 AM



## Michigan Gazehound Association

[michiangazehound.com](http://michiangazehound.com)

## All Breed Lure Coursing Tests

LICENSED BY THE AMERICAN KENNEL CLUB

### All Breed JC / QC

Friday, June 28, 2023, #2024261001

**Cowan Farm  
9809 River Rd**

**Bellevue, MI**

**Junior Courser (JC) & Qualified Courser (QC) Test Fees  
\$10 early entry or \$15 at gate for each entry**

Make checks payable to "MGA" in US funds. Mail to...  
Jessica Epstein  
984 Merry Ln  
Leslie MI 49251

Do NOT send entries "signature required".

*The Field Trial Secretary cannot accept conditional, unsigned, incomplete or unpaid entries; please check your completed entry carefully. Entries by e-mail will not be accepted.*



**American  
Kennel Club®**

CERTIFICATION Permission has been granted by the American Kennel Club for the holding of this event under the American Kennel Club rules and regulations.

**GINA M. DINARDO, Executive Secretary**

## **MICHIGAN GAZEHOUD ASSOCIATION**

President—Matt Botzau; Vice President—Lianna Frazer  
Secretary—Jessica Epstein; Treasurer—Cathy  
Kirchmeyer; Director—Echo Prafke-Marson

## **JUDGES & ASSIGNMENTS**

### **Marni Smith, Ontario**

Marni will judge both JC and QC

JC/QC tests will be run before the Breed Specialties lure coursing trials.

## **FIELD COMMITTEE**

Field Trial Chair: Michelle Hogan 20836 Hall Rd PMB 327 Clinton Twp, MI 48038

Email: [pandorabasenjis@gmail.com](mailto:pandorabasenjis@gmail.com) Phone: (586) 246-6261

Field Trial Secretary: Jessica Epstein, 984 Merry Ln, Leslie MI 49251

Email: [wolfpine8@gmail.com](mailto:wolfpine8@gmail.com) Phone: 517-749-1115

Lure Operator: Matt Botzau, Denis Seeley, Joe Shoemaker,  
Jarret Teamer, Echo Prafke-Marson, Meg Willis-Redfern

Additional Members: Jill Botzau, Lianna Frazer, Diane Guest, Suzanne LaCroix, David Matt, Vicki Roll

TRIAL HOURS: 9:30 AM – until completion

## **ROLL CALL & INSPECTION**

JC/QC Hounds at 10:30 AM

Early acceptance of hounds may begin prior to the times listed above.

## **RIBBONS**

JC Test / QC Test Dark Green.

## **ELIGIBILITY**

Only purebred Afghan Hound, Azawakh, Basenji, Borzoi, Cirneco dell'Etna, Greyhound, Ibizan Hound, Italian Greyhound, Irish Wolfhound, Norrbottenspet, Peruvian Inca Orchid, Pharaoh Hound, Portuguese Podengo, Portuguese Podengo Pequeno, Rhodesian Ridgeback, Saluki, Sloughi, Scottish Deerhound, Thai Ridgeback, and Whippet that are one year of age or older and have been registered with The American Kennel Club or an AKC recognized foreign registry or that have been granted an Indefinite Listing Privilege (ILP) may be entered. Breed disqualifications apply.

## **TESTS OFFERED**

**Junior Courser (JC):** Open to all eligible sighthounds. A hound running alone must receive a certification from a Judge on one date, and a second certification from a different Judge at a later date, with each Judge stating that the hound completed a (minimum) 600-yard course with a minimum of 4 turns. The hound must complete the entire course with enthusiasm and without interruption. Ribbons (Dark Green) will be awarded to all hounds that successfully complete the AKC Junior Courser Test.

**Qualifying Courser (QC):** Open to all eligible sighthounds. The qualifying hound will run with another hound, completing a (minimum) 600-yard course with a minimum of 5 turns. The qualifying hound must complete the entire course with enthusiasm, without interruption, and without coursing, interfering with, or aggressing on the other hound. Owner of qualifying dog must provide or arrange for a hound of like running style for their hound to run with in this test.

## **COURSE PLANS**

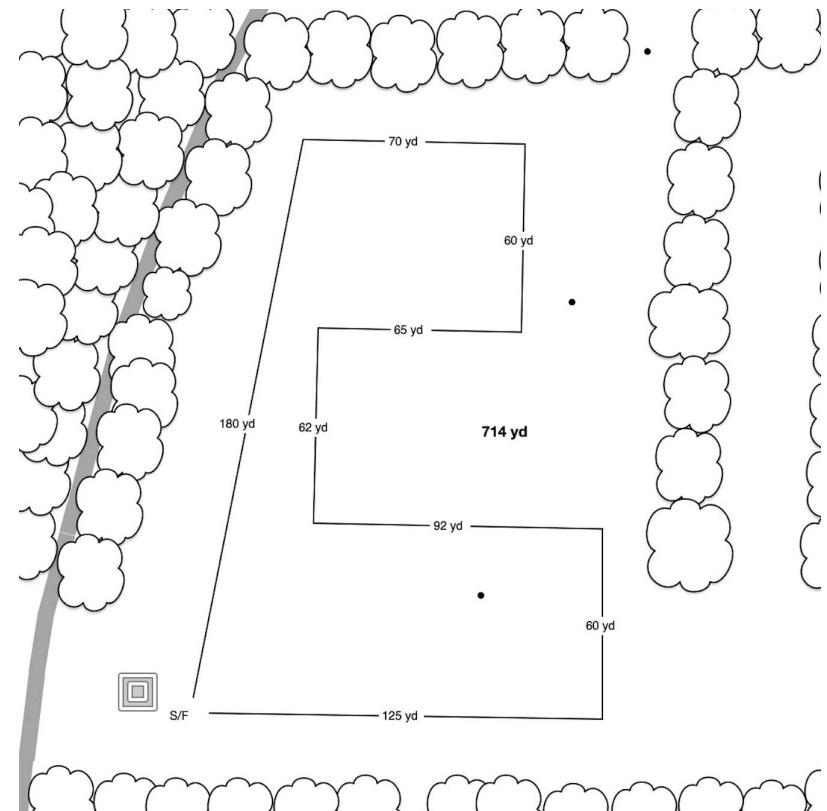

## NOTICE TO ALL EXHIBITORS

All entries must be one year of age or older on the day of the trial.

Hounds not present at the time of roll call will be scratched after a 5-minute grace period and no refund will be given.

Bitches in season and lame hounds will be excused. Entries will be refunded. These are the only reasons that pre-entries will be refunded after the pre-entry closing date.

There will be a minimum \$25 returned check charge.

Hounds will be checked for breed disqualifications. Spayed and neutered hounds are eligible to participate. Monorchid and cryptorchid hounds are ineligible to participate.

Owners of hounds entered for a QC run are responsible for providing and/or arranging for the additional hound to run with.

A \$5.00 fine will be assessed for any loose hound on the field that is not competing in the course in progress.

A \$5.00 fine will be assessed for any handler not cleaning up after their hound.

Gas powered, continuous loop equipment will be used. Lures consist of white or black plastic.

MGA reserves the right to alter course due to field and/or weather conditions on the day of the trial.

The field is not fenced; adequate shade and cool/drinking water should be provided by the participants.

Any person may, upon reasonable complaint, be asked to leave the grounds by the Field Committee. Children **MUST** be under control of their parents or guardians at all times.

Only the Lure Operator, Huntmaster, Judges and Handlers of the hounds running in the course in progress will be permitted near the lure machine.

All dogs run at owners' sole risk. The hosting clubs and property owners, their agents, members, representatives, volunteers, etc. assume no responsibility for any loss, damage, or injury sustained by exhibitors and handlers or to any of their dogs or property and further assumes no responsibility for injury to children or spectators before, during, or after this event.

## Notes for the Day

- ❖ If you have ANY questions about what tests to enter your dog, e-mail the field trial secretary.
- ❖ **BRING YOUR OWN FOOD AND WATER. Lunch will NOT be available** for purchase on-site.
- ❖ Make sure to bring shade and water for your hounds.
- ❖ All hounds finishing their QC titles are eligible to run in Open BUT IT IS ONLY ENCOURAGED if they've run more than just the QC with another hound, and have run cleanly without coursing another hound or interfering in any way.
- ❖ Your hound does not need a JC to enter a trial, but the JC still appears as a title after your hounds name if they earn it.
- ❖ There will be a portable toilet on site.
- ❖ If you are new to the sport, grab someone and ask questions! We're always happy to help "newbies" learn the ropes!
- ❖ **Garbage cans will be onsite for food, dog poop etc. Please respect this field and pick up after yourself. DO NOT LEAVE unwanted items such as busted canopies, large trash, etc. Take that with you!**

### **How to enter your dog and earn AKC Titles**

- ✓ **Your dog must first earn a Qualifying Courser (QC) certification.** Be sure to CHECK OFF "QC" ON THE ENTRY FORM.
- ✓ Next, if your dog has practiced successfully with other dogs (not interfering either aggressively OR playfully), you should enter him in Open and work towards the Senior Courser (SC) title. If your dog also wins a placement he will earn points towards his Field Championship (see point scale below). CHECK "OPEN" ON THE ENTRY FORM, AND PAY THE ENTRY FEE FOR OPEN. There is no additional fee for the SC leg. To earn the SC title, the hound must run with at least one other hound, and must receive qualifying scores at FOUR (4) AKC trials under two different judges or judging panels.
- ✓ When your dog has earned the SC title, he most likely will still be competing for Field Championship points. If he receives qualifying scores in 25 trials, he will earn the Master Courser (MC) title.
- ✓ The title of Field Champion (FC) is a prefix to a hound's name. It is earned by obtaining 15 points from the Open or Veteran stakes. Dog must win 2 first placements worth 3 or more points under two different judges or judging panels (majors).
- ✓ A dog who has earned his Field Champion title must be entered in the Specials Stake or, if eligible, the Veteran Stake.



June 29, 2024 after the trial in the camping area  
TACO BAR: MGA will provide meat (Ground Beef & Chicken)  
Please bring a dish to pass and your own beverage

### HOW TO ENTER

Scanned/E-mailed entries are acceptable. However, payment **MUST** be made at the time of sending entries using the payment option on the Michigan Gazehound Association website. The email payment confirmation you receive from PayPal can be forwarded to the FTS as proof of payment.

MAILED entries may be paid by either a check in US Funds or by using the payment button at the Michigan Gazehound Association Website.

Online entries are also accepted via the AKC entry forms for sighthounds at the Michigan Gazehound Association website. Payment can be made after submitting your online entries.

### NO EXCEPTIONS.

If you have **NOT** provided payment by roll call on the day of trial, your entry will be considered conditional and not accepted.

Instructions on how to Enter and Pay **ONLINE** can be found on the Online Entries Page on the Michigan Gazehound Association website:  
<https://www.michigangazehound.com/online-entries>



Official American Kennel Club Lure Coursing Entry Form

|  |  |  |
|--|--|--|
| Club:<br><b>Michigan Gazehound Association</b>   | Date:<br><b>Fri 28 June 2024</b>   | Event #:<br><b>2024261001</b>                        |
| Location:<br><b>Cowan Farms, Bellevue, MI</b>  | Event type (test or trial):<br><input checked="" type="checkbox"/> Test <input type="checkbox"/> Trial                 |  |
| Stakes: <input type="checkbox"/> JC <input type="checkbox"/> CAT <input type="checkbox"/> Special<br><input type="checkbox"/> FCAT <input type="checkbox"/> OC <input type="checkbox"/> Open <input type="checkbox"/> Veteran  | Breed:   | Amount of entry fees enclosed: \$                    |
| Breeder:   | AKC No. <input type="checkbox"/> PAL/JLP No. <input type="checkbox"/> Foreign & List Country: <input type="checkbox"/> | Date of Birth:                                       |
| Call Name:   | AKC No.:   | Sex:   |
| Name of Jr. Handler (if any):  | Jr Handler #:  |  |
| Full Name of Dog:  |  |  |
| Sire:  |  |  |
| Dam:   |  |  |
| Actual Owner(s):   |  |  |
| Owner's Address:   |  |  |
| City:  | State:   | Zip:   |
| Name of Owner's Agent/Handler (if any) at Trial:   |  | <input type="checkbox"/> Please Separate My Entries. |
| <p>AKC Rules, Regulations, Policies and Guidelines are available on the American Kennel Club website: <a href="http://www.akc.org">www.akc.org</a></p> <p><b>AGREEMENT</b></p> <p>I certify that I am the actual owner of the dog, or that I am the duly authorized agent of the actual owner whose name I have entered above. In consideration of the acceptance of this entry, I (we) agree to abide by the rules and regulations of The American Kennel Club in effect at the time of this event, and any additional rules and regulations appearing in the premium list of this event and entry form and any decision made in accord with them. I (we) agree that the club holding this event has the right to refuse this entry for cause which the club shall deem sufficient. I (we) certify and represent that the dog entered is not a hazard to persons or other dogs. In consideration of the acceptance of this entry and of the holding of this event and of the opportunity to have the dog judged and to win prizes, ribbons, or trophies, I (we) agree to hold the AKC, the event-giving club, their members, directors, governors, officials, agents, superintendents or event secretary and the owner and/or lessor of the premises and any provider of services that are necessary to hold this event and any employees or volunteers of the aforementioned parties, and any AKC approved judge, judging at this event, harmless from any claim for loss or injury which may be alleged to have been caused directly or indirectly to any person or thing by the act of this dog while in or about the event premises or grounds or near any entrance thereto, and I (we) personally assume all responsibility and liability for any such claim, and I (we) further agree to hold the aforementioned parties harmless from any claim for loss, injury or damage to this dog. Additionally, I (we) hereby assume the sole responsibility for and agree to indemnify, defend and save the aforementioned parties harmless from any and all loss and expense (including legal fees) by reason of the liability imposed by law upon any of the aforementioned parties for damage because of bodily injuries, including death at any time resulting therefrom, sustained by any person or persons, including myself (ourselves), or on account of damage to property, arising out of or in consequence of my (our) participation in this event, however such injuries, death or property damage may be caused, and whether or not the same may have been caused or may be alleged to have been caused by the act of this dog while in or about the event premises or grounds or near any entrance thereto, and I (we) agree that the determination of whether the injury is serious shall be made by the event veterinarian and is binding on me (us). I (WE) AGREE THAT ANY CAUSE OF ACTION, CONTROVERSY OR CLAIM ARISING OUT OF OR RELATED TO THE ENTRY, EXHIBITION OR ATTENDANCE AT THE EVENT BETWEEN THE AKC AND THE EVENT-GIVING CLUB (UNLESS OTHERWISE STATED IN THIS PREMIUM LIST) AND MYSELF (OURSELVES) OR AS TO THE CONSTRUCTION, INTERPRETATION AND EFFECT OF THIS AGREEMENT SHALL BE SETTLED BY ARBITRATION PURSUANT TO THE APPLICABLE RULES OF THE AMERICAN ARBITRATION ASSOCIATION. HOWEVER, PRIOR TO ARBITRATION ALL APPLICABLE AKC BYLAWS, RULES, REGULATIONS AND PROCEDURES MUST FIRST BE FOLLOWED AS SET FORTH IN THE AKC CHARTER AND BYLAWS, RULES, REGULATIONS, PUBLISHED POLICIES AND GUIDELINES.</p> |  |  |
| Signature of owner or agent duly authorized to make this entry:  |  |  |
| Tel:   | Email:   |  |

Official American Kennel Club Lure Coursing Entry Form

|   |  |  |
|---|--|--|
| Club:<br><b>Michigan Gazehound Association</b>  | Date:<br><b>Fri 28 June 24</b>   | Event #:<br><b>2024261001</b>                        |
| Location:<br><b>Cowan Farm, Bellevue, MI</b>  | Event type (test or trial):<br><input checked="" type="checkbox"/> Test <input type="checkbox"/> Trial                 |  |
| Stakes: <input type="checkbox"/> JC <input type="checkbox"/> CAT <input type="checkbox"/> Special<br><input type="checkbox"/> FCAT <input type="checkbox"/> OC <input type="checkbox"/> Open <input type="checkbox"/> Veteran   | Breed:   | Amount of entry fees enclosed: \$                    |
| Breeder:  | AKC No. <input type="checkbox"/> PAL/JLP No. <input type="checkbox"/> Foreign & List Country: <input type="checkbox"/> | Date of Birth:                                       |
| Call Name:  | AKC No.:   | Sex:   |
| Name of Jr. Handler (if any):   | Jr Handler #:  |  |
| Full Name of Dog:   |  |  |
| Sire:   |  |  |
| Dam:  |  |  |
| Actual Owner(s):  |  |  |
| Owner's Address:  |  |  |
| City:   | State:   | Zip:   |
| Name of Owner's Agent/Handler (if any) at Trial:  |  | <input type="checkbox"/> Please Separate My Entries. |
| <p>AKC Rules, Regulations, Policies and Guidelines are available on the American Kennel Club website: <a href="http://www.akc.org">www.akc.org</a></p> <p><b>AGREEMENT</b></p> <p>I certify that I am the actual owner of the dog, or that I am the duly authorized agent of the actual owner whose name I have entered above. In consideration of the acceptance of this entry, I (we) agree to abide by the rules and regulations of The American Kennel Club in effect at the time of this event, and any additional rules and regulations appearing in the premium list of this event and entry form and any decision made in accord with them. I (we) agree that the club holding this event has the right to refuse this entry for cause which the club shall deem sufficient. I (we) certify and represent that the dog entered is not a hazard to persons or other dogs. In consideration of the acceptance of this entry and of the holding of this event and of the opportunity to have the dog judged and to win prizes, ribbons, or trophies, I (we) agree to hold the AKC, the event-giving club, their members, directors, governors, officials, agents, superintendents or event secretary and the owner and/or lessor of the premises and any provider of services that are necessary to hold this event and any employees or volunteers of the aforementioned parties, and any AKC approved judge, judging at this event, harmless from any claim for loss or injury which may be alleged to have been caused directly or indirectly to any person or thing by the act of this dog while in or about the event premises or grounds or near any entrance thereto, and I (we) personally assume all responsibility and liability for any such claim, and I (we) further agree to hold the aforementioned parties harmless from any claim for loss, injury or damage to this dog. Additionally, I (we) hereby assume the sole responsibility for and agree to indemnify, defend and save the aforementioned parties harmless from any and all loss and expense (including legal fees) by reason of the liability imposed by law upon any of the aforementioned parties for damage because of bodily injuries, including death at any time resulting therefrom, sustained by any person or persons, including myself (ourselves), or on account of damage to property, arising out of or in consequence of my (our) participation in this event, however such injuries, death or property damage may be caused, and whether or not the same may have been caused or may be alleged to have been caused by the negligence of the aforementioned parties or any of their employees, agents, or any other person. I (we) agree that the determination of whether the injury is serious shall be made by the event veterinarian and is binding on me (us). I (WE) AGREE THAT ANY CAUSE OF ACTION, CONTROVERSY OR CLAIM ARISING OUT OF OR RELATED TO THE ENTRY, EXHIBITION OR ATTENDANCE AT THE EVENT BETWEEN THE AKC AND THE EVENT-GIVING CLUB (UNLESS OTHERWISE STATED IN THIS PREMIUM LIST) AND MYSELF (OURSELVES) OR AS TO THE CONSTRUCTION, INTERPRETATION AND EFFECT OF THIS AGREEMENT SHALL BE SETTLED BY ARBITRATION PURSUANT TO THE APPLICABLE RULES OF THE AMERICAN ARBITRATION ASSOCIATION. HOWEVER, PRIOR TO ARBITRATION ALL APPLICABLE AKC BYLAWS, RULES, REGULATIONS AND PROCEDURES MUST FIRST BE FOLLOWED AS SET FORTH IN THE AKC CHARTER AND BYLAWS, RULES, REGULATIONS, PUBLISHED POLICIES AND GUIDELINES.</p> |  |  |
| Signature of owner or agent duly authorized to make this entry:   |  |  |
| Tel:  | Email:   |  |

## ADDITIONAL NOTES ABOUT QC RUNS

- All dogs entering the Open stake must now earn a Qualifying Courser certification. (Unless said hound has run in the open or open veteran stake in a trial prior to Jan. 1. 2010, holds a field champion title from ASFA or CKC, or holds a Hound Certification from ASFA – a copy of such title or certification needs to accompany the hounds first trial entry).
- You are responsible for finding a hound of like running style to run your QC hound with. You cannot expect to run your hound for a QC without arranging for another hound to help certify yours.
- **You will be handed a form to fill out at roll call. You must fill this out and RETURN it to the Field Trial Secretary BEFORE the QC runs are to begin – THIS IS IMPORTANT! Make sure you have your hound's AKC Registration Number with you.**
- Once your hound has completed its QC **and the judge has come off the field**, please see the Field Trial Secretary to retrieve your certification form. You will need to attach this (or a copy of it) to your hound's first official entry into the Open or Open Veteran stake.
- The JC test is no longer required AT ALL to enter the open stake and, in fact, a hound may have a JC title but **without the QC** (or other stated requirements) **a hound MAY NOT enter the Open or Open Veteran stake at a trial.**
- If you have any questions about this – please contact your Field Trial Secretary.
- This weekend we will be running ALL QC runs (and JC tests) AFTER the trial.
- 



AMERICAN  
KENNEL CLUB®

## Qualified Courser Certificate

***Instructions:** This form is to be used when a hound successfully completes the Qualified Courser Test at an AKC Lure Coursing event. A hound must have received this certification to be eligible to compete in an AKC Lure Coursing Trial in the Open or Open Veteran stake. This form must be properly completed and submitted along with this hound's first entry in an AKC Lure Coursing Trial in either stake.*

*\* Hounds who have earned a Field Championship from either the American Sighthound Field Association (ASFA) or the Canadian Kennel Club (CKC) are exempt from this requirement. A copy of the applicable FC certificate must accompany the first entry of these hounds.*

To be completed by owner/agent:

Breed \_\_\_\_\_ Call Name \_\_\_\_\_

AKC® Registered Name \_\_\_\_\_

AKC Registration Number \_\_\_\_\_

I hereby certify that the hound running in the Qualifying Course is the hound identified above and the information provided is true and correct.

Printed Name of Owner/Agent \_\_\_\_\_

Signature of Owner/Agent \_\_\_\_\_ Date \_\_\_\_\_

---

To be completed by certifying judge:

I hereby certify that the above referenced hound passed the Qualified Courser Test by running clean with another hound of the same breed or one with a similar running style completing a course a minimum of 600 yards.

Judge's Printed Name \_\_\_\_\_ Judge's Number \_\_\_\_\_

Judge's Signature \_\_\_\_\_ Date \_\_\_\_\_