

DIRECTIONS TO THE SITE

From the West (Lansing) on I96, take the Williamston Rd exit 117A toward Dansville. Turn right onto Williamston Rd 1.3 miles turn left onto Holt Rd. 1.0 mile turn right onto N. Meech Rd. About 0.7 miles the farm will be on the right. From the East (Webberville, Howell) on I96, turn left onto M-43 E/M-52 S/Stockbridge Rd. Continue to follow M-52 S/Stockbridge Rd for 1.1 miles. Turn right onto Holt Rd. 3.3 miles turn left onto Meech Rd. About 0.7 miles the farm will be on the right.

HOTELS (check for current dog policies and restrictions)

- Hyatt Place - Lansing East, 2401 Showtime Dr., Lansing MI (\$75 pet fee) 517-679-7600
- Best Western, 2209 University Park Dr., Okemos MI (\$25 per dog pet fee) 517-349-8700
- Candlewood Suites 3545 Forest Rd Lansing, MI (Pet fee) 517-351-8181
- Hampton Inn & Suites, 2200 Hampton Pl., Okemos, MI (pet fee) 517-349-6100
- Holiday Inn Express & Suites, 2350 Jolly Oak Rd., Okemos, MI (\$25.00 per dog pet fee) 517-999-8700 ext. 500
- HomeTown Studios, 2335 Woodlake Dr., Okemos, MI. (\$10.00 per dog per day pet fee) 517-347-1000
- Red Roof Inn, 3615 Dunckel Rd., Lansing, MI (one dog per room but inquire when you call as sometimes they are flexible) 517-332-2575
- Comfort Inn Okemos 2187 University Park Dr, Okemos, MI 48864 (Pet Fee) 517-347-6690
- Residence Inn Marriott, 922 Delta Commerce Dr., Lansing, MI. 517-886-5030
- Staybridge Suites, 3553 Meridian Crossing Dr., Okemos, MI (pet fee). 517-347-3044
- Check bringfido.com as there are a number of airbnb, vrbo and hotels listed there for the area.

CAMPING

Permitted on site. Dry Camping only. No hookups, no water, no electricity. Bigger rigs need to check with FTS before signing up for camping. \$20 per night

EMERGENCY VETERINARIAN

Greater Lansing Veterinary Center

1290 W Grand River Ave Suite 500, Williamston, MI 48895 517-708-2525

Entrance to the field, Day parking and Camping



PREMIUM LIST

Early entries close on Wednesday, June 25, 2025 at 9:00 PM

Gate entries close on the day of the event at 11:00 AM



Basenji Club of America

www.basenji.org

Basenji Specialty Lure Coursing Trial

AKC Member Club

Friday, June 27, 2025, #2025000701

Tazidan Farm

1629 N Meech Rd

Williamston, MI

Open/Specials/Veteran/Singles Stake Trial Fees

\$25 for first hound \$18 for each additional hound for early entry or

\$30 at gate for each entry

\$10 each for Kennel/Breeder

Make checks payable to "MGA" in US funds. Mail to...

Jessica Epstein

984 Merry Ln

Leslie MI 49251

Do NOT send entries "signature required".

The Field Trial Secretary cannot accept conditional, unsigned, incomplete or unpaid entries; please check your completed entry carefully. Entries by e-mail will not be accepted.



**AMERICAN
KENNEL CLUB**

CERTIFICATION Permission has been granted by the American Kennel Club for the holding of this event under the American Kennel Club rules and regulations.

SHEILA H. GOFFE, Executive Secretary

Basenji Club of America

President -Natalie Scherwin; Vice President -Julie Hartigan
Secretary -Janet Ketz; Treasurer -Laura Mae Hesse
Directors -Jon Curby, Michelle Hogan, Stella Sapios, Julie Jones, Pat Marshall, Veronica Nagy, Thomas Wright

JUDGE & ASSIGNMENTS

Judy Lowther Cleveland, OH
Don White Grove City, OH

The judges are assigned to all basenjjs.
Stakes will run in order of: Open, Specials, Veteran and Singles.

FIELD COMMITTEE

Field Trial Chair: Michelle Hogan 20836 Hall Rd PMB 327 Clinton Twp, MI 48038

Email:pandorabasenjis@gmail.comPhone: (586) 246-6261

Field Trial Secretary: Jessica Epstein, 984 Merry Ln, Leslie MI 49251

Email: wolfpine8@gmail.com Phone: 517-749-1115

Lure Operator: Matt Botzau, Denis Seeley, Joe Shoemaker

Additional Members: Lianna Frazer, Kelli Harmon, Suzanne LaCroix

TRIAL HOURS:11:00AM until completion

ROLL CALL & INSPECTION

Trial Hounds at 11:15 AM.

Early acceptance of hounds may begin ½ hour prior to the times listed above.

RIBBONS

First -Blue, Second -Red, Third -Yellow, Fourth -White, Fifth -Pink.
Best of Breed-Purple & Gold Rosette.

Rosettes offered for: High Score DC, Kennel Stake, Breeder Stake, Bench Stake,
Additional prizes may be offered by the club or friends of the club.

ELIGIBILITY

Only purebred Basenjjs that are one year of age or older and have been registered with The American Kennel Club or an AKC recognized foreign registry or that have been granted an Indefinite Listing Privilege (ILP) may be entered. Breed disqualifications apply.

All dogs run at owners' sole risk. The hosting clubs and property owners, their agents, members, representatives, volunteers, etc. assume no responsibility for any loss, damage, or injury sustained by exhibitors and handlers or to any of their dogs or property and further assumes no responsibility for injury to children or spectators before, during, or after this event.

TESTS OFFERED

No tests—Junior Courser (JC) or Qualified Courser (QC)—will be offered.

STAKES OFFERED

OPEN: Open only to Basenjjs, with no breed disqualifications, that hold an AKC QC certificate OR have run in the Open Stake prior to Jan. 1, 2010, OR have a Senior Courser title OR have an ASFA or CKC field champion title (a copy of this title must be attached to the entry form if the QC requirement is to be waived) OR have an ASFA Hound Certification (a copy of which must be attached to the entry form if the QC requirement is to be waived). Championship points are awarded from this stake. Hounds under disqualification from AKC, ASFA or CKC Field Trials may **NOT** be entered.

SPECIALS: Open only to Basenjjs that are eligible to enter the Open Stake **and** have earned their AKC Field Championship title. LCX points may be awarded from this stake. Hounds under disqualification from AKC, ASFA or CKC Field Trials may **NOT** be entered.

VETERAN: Open only to Basenjjs that are eligible to enter either Open or Specials Stake, and are of Veteran age as determined by their Parent Breed Club (6 years for Basenjjs). Championship or LCX points may be awarded from this stake. Hounds under disqualification from AKC, ASFA or CKC Field Trials may **NOT** be entered.

SINGLES: Open to all Basenjjs of eligible breed, including those that are otherwise disqualified from entering the regular stakes (Open, Specials, and Veteran). Hounds entered in the Singles Stake may not also enter a regular stake at the same event. NO championship or LCX points are awarded from this stake.

BEST IN FIELD (BIF): Will not be offered.

NON-REGULAR STAKES OFFERED

KENNEL STAKE: For two Basenjjs, designated at the time of entry, entered in any of the stakes, owned and kenneled by the same person.

BREEDER STAKE: For two Basenjjs, designated at the time of entry, entered in any of the stakes. Both Basenjjs must have at least one breeder in common. A hound may only be part of any one Kennel and one Breeder stake entry.

BENCH STAKE: For Basenjjs that have been awarded the AKC Bench Championship by the closing of the entries. The championship status of the winner must be verifiable.

HIGH SCORING DC: For AKC FC Basenjjs that have been awarded the AKC Bench Championship by the closing date of entries. The championship status of the winner must be verifiable.

NOTE: There is no entry fee for the Bench or Dual Champion Stake awards but the appropriate boxes **MUST BE CHECKED ON YOUR ENTRY FORM.**

COURSE PLAN

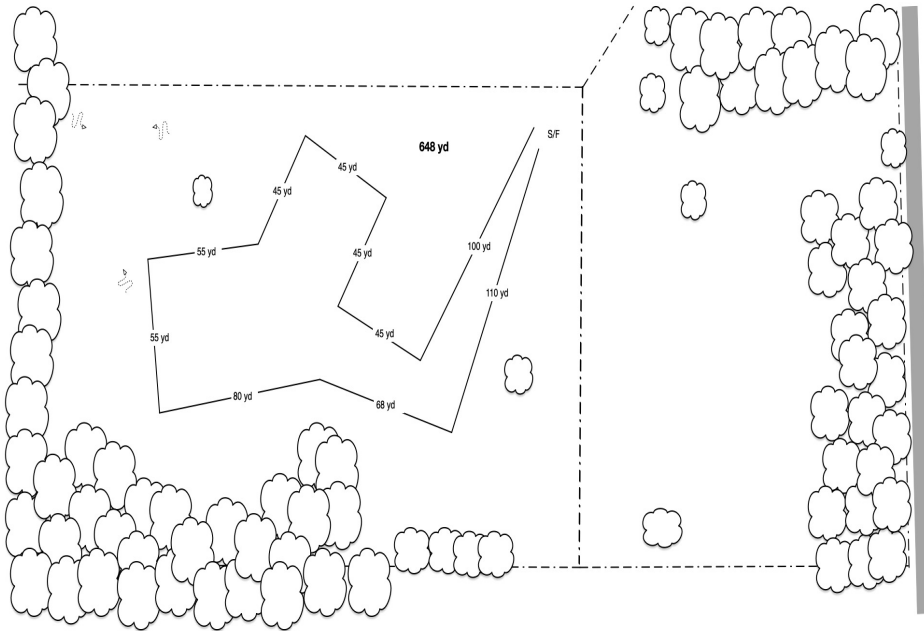

Course will be reversed for finals, run-offs and BOB.

The field committee reserves the right to alter the course due to field and/or weather conditions on the day of the trial.

NOTICE TO ALL EXHIBITORS

All entries must be one year of age or older on the day of the trial.

Registrations cannot be pending.

Hounds not present at the time of roll call will be scratched after a 5-minute grace period and no refund will be given.

Stakes may be split if sufficient entries are present in any one stake at the time of the draw to support more than one 5-point major.

Bitches in season and lame hounds will be excused. Entries will be refunded. These are the only reasons that pre-entries will be refunded after the pre-entry closing date.

All attempts will be made to separate hounds that have the same owner and live in the same household or being handled by the same person - these entries **MUST** be submitted together to qualify.

There will be a minimum \$25 returned check charge.

Hounds will be checked for breed disqualifications. Spayed and neutered hounds are eligible to participate. Monorchid and cryptorchid hounds are ineligible to participate.

A \$5.00 fine will be assessed for any loose hound on the field that is not competing in the course in progress.

A \$5.00 fine will be assessed for any handler not cleaning up after their hound.

The field is not fenced; adequate shade and cool/drinking water should be provided by the participants.

Gas powered, continuous loop equipment will be used. Lures consist of white or black plastic.

Only the Lure Operator, Huntmaster, Judges and Handlers of the hounds running in the course in progress will be permitted near the lure machine.

Any person may, upon reasonable complaint, be asked to leave the grounds by the Field Committee. Children **MUST** be under control of their parents or guardians at all times.

Four clubs are hosting AKC lure coursing events on this weekend. On Friday, Michigan Gazehound Association is holding all breed JC/QC tests. The American Whippet Club (AWC) is hosting a Whippet specialty lure coursing trial, the Basenji Club of America (BCOA) is hosting a Basenji specialty lure coursing trial and the Ibizan Hound Club of the United States (IHCUS) is hosting an Ibizan Hound specialty lure coursing trial. On Saturday and Sunday, Michigan Gazehound Association is hosting trials and tests. The premium for those events may be found on either akc.org or michigangazehound.com. Instructions and forms for camping are included in the premiums for MGA.

All entries for AWC, BCOA, IHCUS and MGA must be paid to MGA, either by check or on-line, as directed in their premiums. All camping fees must be paid separately to MGA and may be submitted with entries to any of one of the 4 clubs.

Instructions on how to Enter and Pay **ONLINE** can be found on the Online Entries Page on the Michigan Gazehound Association website:
<https://www.michigangazehound.com/online-entries>

If entering for AWC, IHCUS or BCOA, please use the appropriate online entry form. On the payment page, please select either BCOA, IHCUS or AWC. If entering both MGA and BCOA, IHCUS or AWC, you can submit one form.

Official American Kennel Club Lure Coursing Entry Form

Club: Basenji Club of America	Date: 6/27/25	Event #: 2025000701
Location: Tazidan Farm	Event type (test or trial): <input type="checkbox"/> Test <input type="checkbox"/> Trial	
Stakes: <input type="checkbox"/> JC <input type="checkbox"/> CAT <input type="checkbox"/> Special <input type="checkbox"/> FCAAT <input type="checkbox"/> MC <input type="checkbox"/> Open <input type="checkbox"/> Veteran	Breed:	Amount of entry fees enclosed: \$
Breeder:	AKC No. <input type="checkbox"/> PAL/ILP No. <input type="checkbox"/> Foreign & List Country: <input type="checkbox"/>	Date of Birth:
Call Name:	AKC No:	Sex:
Name of Jr. Handler (if any):		Jr Handler #:
Full Name of Dog:		
Sire:		
Dam:		
Actual Owner(s):		
Owner's Address:		
City:	State:	Zip:
Name of Owner's Agent/Handler (if any) at Trial:		<input type="checkbox"/> Please Separate My Entries.
<p>AKC Rules, Regulations, Policies and Guidelines are available on the American Kennel Club website: www.akc.org</p> <p align="center">AGREEMENT</p> <p>I certify that I am the actual owner of the dog, or that I am the duly authorized agent of the actual owner whose name I have entered above. In consideration of the acceptance of this entry, I (we) agree to abide by the rules and regulations of The American Kennel Club in effect at the time of this event, and any additional rules and regulations appearing in the premium list of this event and entry form and any decision made in accord w/ them. I (we) agree that the club holding this event has the right to refuse this entry for cause which the club shall deem sufficient. I (we) certify and represent that the dog entered is not a hazard to persons or other dogs. In consideration of the acceptance of this entry and of the holding of this event and of the opportunity to have the dog judged and to win prizes, ribbons, or trophies, I (we) agree to hold the AKC, the event giving club, their members, directors, governors, officers, agents, superintendents or event secretary and the owner and/or lesser of the premises and any provider of services that are necessary to hold this event and any employees or volunteers of the aforementioned parties, and any AKC approved judge, judging at this event, harmless from any claim for loss or injury which may be alleged to have been caused directly or indirectly to any person or thing by the act of this dog while in or about the event premises or grounds or near any entrance thereto, and I (we) personally assume all responsibility and liability for any such claim, and I (we) further agree to hold the aforementioned parties harmless from any claim for loss, injury or damage to this dog. Additionally, I (we) hereby assume the sole responsibility for and agree to indemnify, defend and save the aforementioned parties harmless from any and all loss and expense (including legal fees) by reason of the liability imposed by law upon any of the aforementioned parties for damage because of bodily injuries, including death at any time resulting therefrom, sustained by any person or persons, including myself (ourselves), or on account of damage to property, arising out of or in consequence of my (our) participation in this event, however such injuries, death or property damage may be caused, and whether or not the same may have been caused or may be alleged to have been caused by the negligence of the aforementioned parties or any of their employees, agents, or any other person. I (we) agree that the determination of whether the injury is serious shall be made by the event veterinarian and is binding on me (us). I (WE) AGREE THAT ANY CAUSE OF ACTION, CONTROVERSY OR CLAIM ARISING OUT OF OR RELATED TO THE ENTRY, EXHIBITION OR ATTENDANCE AT THE EVENT BETWEEN THE AKC AND THE EVENT-GIVING CLUB (UNLESS OTHERWISE STATED IN THIS PREMIUM LIST) AND MYSELF (OURSELVES) OR AS TO THE CONSTRUCTION, INTERPRETATION AND EFFECT OF THIS AGREEMENT SHALL BE SETTLED BY ARBITRATION PURSUANT TO THE APPLICABLE RULES OF THE AMERICAN ARBITRATION ASSOCIATION. HOWEVER, PRIOR TO ARBITRATION ALL APPLICABLE AKC BYLAWS, RULES, REGULATIONS AND PROCEDURES MUST FIRST BE FOLLOWED AS SET FORTH IN THE AKC CHARTER AND BYLAWS, RULES, REGULATIONS, PUBLISHED POLICIES AND GUIDELINES.</p>		
Signature of owner or agent duly authorized to make this entry:		
Tel:	Email:	

Official American Kennel Club Lure Coursing Entry Form

Club: Basenji Club of America	Date: 6/27/25	Event #: 2025000701
Location: Tazidan Farm	Event type (test or trial): <input type="checkbox"/> Test <input type="checkbox"/> Trial	
Stakes: <input type="checkbox"/> JC <input type="checkbox"/> CAT <input type="checkbox"/> Special <input type="checkbox"/> FCAAT <input type="checkbox"/> MC <input type="checkbox"/> Open <input type="checkbox"/> Veteran	Breed:	Amount of entry fees enclosed: \$
Breeder:	AKC No. <input type="checkbox"/> PAL/ILP No. <input type="checkbox"/> Foreign & List Country: <input type="checkbox"/>	Date of Birth:
Call Name:	AKC No:	Sex:
Name of Jr. Handler (if any):		Jr Handler #:
Full Name of Dog:		
Sire:		
Dam:		
Actual Owner(s):		
Owner's Address:		
City:	State:	Zip:
Name of Owner's Agent/Handler (if any) at Trial:		<input type="checkbox"/> Please Separate My Entries.
<p>AKC Rules, Regulations, Policies and Guidelines are available on the American Kennel Club website: www.akc.org</p> <p align="center">AGREEMENT</p> <p>I certify that I am the actual owner of the dog, or that I am the duly authorized agent of the actual owner whose name I have entered above. In consideration of the acceptance of this entry, I (we) agree to abide by the rules and regulations of The American Kennel Club in effect at the time of this event, and any additional rules and regulations appearing in the premium list of this event and entry form and any decision made in accord w/ them. I (we) agree that the club holding this event has the right to refuse this entry for cause which the club shall deem sufficient. I (we) certify and represent that the dog entered is not a hazard to persons or other dogs. In consideration of the acceptance of this entry and of the holding of this event and of the opportunity to have the dog judged and to win prizes, ribbons, or trophies, I (we) agree to hold the AKC, the event giving club, their members, directors, governors, officers, agents, superintendents or event secretary and the owner and/or lesser of the premises and any provider of services that are necessary to hold this event and any employees or volunteers of the aforementioned parties, and any AKC approved judge, judging at this event, harmless from any claim for loss or injury which may be alleged to have been caused directly or indirectly to any person or thing by the act of this dog while in or about the event premises or grounds or near any entrance thereto, and I (we) personally assume all responsibility and liability for any such claim, and I (we) further agree to hold the aforementioned parties harmless from any claim for loss, injury or damage to this dog. Additionally, I (we) hereby assume the sole responsibility for and agree to indemnify, defend and save the aforementioned parties harmless from any and all loss and expense (including legal fees) by reason of the liability imposed by law upon any of the aforementioned parties for damage because of bodily injuries, including death at any time resulting therefrom, sustained by any person or persons, including myself (ourselves), or on account of damage to property, arising out of or in consequence of my (our) participation in this event, however such injuries, death or property damage may be caused, and whether or not the same may have been caused or may be alleged to have been caused by the negligence of the aforementioned parties or any of their employees, agents, or any other person. I (we) agree that the determination of whether the injury is serious shall be made by the event veterinarian and is binding on me (us). I (WE) AGREE THAT ANY CAUSE OF ACTION, CONTROVERSY OR CLAIM ARISING OUT OF OR RELATED TO THE ENTRY, EXHIBITION OR ATTENDANCE AT THE EVENT BETWEEN THE AKC AND THE EVENT-GIVING CLUB (UNLESS OTHERWISE STATED IN THIS PREMIUM LIST) AND MYSELF (OURSELVES) OR AS TO THE CONSTRUCTION, INTERPRETATION AND EFFECT OF THIS AGREEMENT SHALL BE SETTLED BY ARBITRATION PURSUANT TO THE APPLICABLE RULES OF THE AMERICAN ARBITRATION ASSOCIATION. HOWEVER, PRIOR TO ARBITRATION ALL APPLICABLE AKC BYLAWS, RULES, REGULATIONS AND PROCEDURES MUST FIRST BE FOLLOWED AS SET FORTH IN THE AKC CHARTER AND BYLAWS, RULES, REGULATIONS, PUBLISHED POLICIES AND GUIDELINES.</p>		
Signature of owner or agent duly authorized to make this entry:		
Tel:	Email:	

Michigan Gazehound Association
Williamston Camping Registration

Rates

- \$20/night for primitive camping

Instructions

1. No dumping of any waste water.
 2. Campers must maintain a clean site during the event and upon departure. Take trash with you.
 3. Bigger RVs need to first contact the FTS before submitting this form.
- Please complete form and either...
 - Submit form with payment, which may be included with entries, to the field trial secretary in advance of the event, **OR** Present form and separate payment at the event to FTS.

Camping Request and Registration

Camper Name:

Phone: _____

Address:

Emergency Contact Name and Phone:

Number of people staying on site: _____

Number of nights: _____ Amount paid: _____

I have read the above camping rules and by signing this form will recognize and comply with said terms. Be it understood that in no way shall the owners of Tazidan Farm be held responsible for loss or injury of any character to persons or articles while participating in the event at the Farm.

Signed:

Date: _____

KENNEL & BREEDER STAKE ENTRY

Please submit only ONE form per pair of **hounds** per Stake.

Circle one:  Kennel Stake Breeder Stake

Breeder: _____

#1

Call Name: _____

Registered Name: _____

Owner(s): _____

#2

Call Name: _____

Registered Name: _____

Owner(s): _____

This form MUST accompany entries. Please include
Kennel & Breeder Stake entries with your regular trial entries.

**Breeder & Kennel Stake entries will not be valid until payment
and both dogs' regular trial entries are received.**

KENNEL & BREEDER STAKE ENTRY

Please submit only ONE form per pair of **hounds** per Stake.

Circle one:  Kennel Stake Breeder Stake

Breeder: _____

#1

Call Name: _____

Registered Name: _____

Owner(s): _____

#2

Call Name: _____

Registered Name: _____

Owner(s): _____

This form MUST accompany entries. Please include
Kennel & Breeder Stake entries with your regular trial entries.

**Breeder & Kennel Stake entries will not be valid until payment
and both dogs' regular trial entries are received.**

Dual Champion **STAKE ENTRY**

(one form per entry)

Owner(s): _____

Call Name: _____

Registered Name: _____

Stake entered: (Circle one) Open FCh **Veteran**

1) Proof of title must accompany entry.

2) This form must accompany entries.

BENCH STAKE ENTRY

(one form per entry)

Owner(s): _____

Call Name: _____

Registered Name: _____

Stake entered: (Circle one) Open FCh **Veteran** **Single**

1) Proof of title must accompany entry.

2) This form must accompany entries.

Dual Champion **STAKE ENTRY**

(one form per entry)

Owner(s): _____

Call Name: _____

Registered Name: _____

Stake entered: (Circle one) Open FCh **Veteran**

1) Proof of title must accompany entry.

2) This form must accompany entries.

BENCH STAKE ENTRY

(one form per entry)

Owner(s): _____

Call Name: _____

Registered Name: _____

Stake entered: (Circle one) Open FCh **Veteran** **Single**

1) Proof of title must accompany entry.

2) This form must accompany entries.

AKC Breed Speciality COURSING

One Stop Shopping Sheet

Name:				
Address:				
City, State, ZIP:				
Phone:				
E-mail:				
		Quantity	Each	Price
Entries (include <u>separated</u> form(s) from premium for each hound)	First Dog	1	x \$ 25	\$ 25.00
	Additional Dogs		x \$ 18	\$
Breeder Stake (include one form per pair)	How many pairs?		x \$ 10	\$
Kennel Stake (include one form per pair)	How many pairs?		x \$ 10	\$
Bench Stake (include form and copy of bench CH certificate)	How many individual hounds?		x \$ 0	\$
Dual Champion (include proof of bench CH certificate)	How many individual hounds?		x \$ 0	
General Trophy Donation: General Trophy sponsorships are still available, and much appreciated! Visit www.houndsofamerica.com				
		Total		

Make check payable in USD to MGA and mail to:

Jessica Epstein
984 Merry Ln
Leslie, MI 49251

PLEASE INCLUDE THIS WORKSHEET WITH YOUR MAILED ENTRIES.