

## DIRECTIONS TO THE SITE

From I-69N or S – Exit at M78 (Butterfield Hwy) (Exit 48). Take M78 West towards Bellevue. At the stop light, turn left to continue on M78 W. In about 1.2 miles turn left on River Rd. Farm is about 1.7 miles on the left.

## HOTELS

Check pet policies and restrictions before reserving rooms. Some may have changed or have a limit in dogs.

### Battle Creek - I94

Red Roof Inn, 5050 Beckley Rd, Battle Creek 937-328-1821

### Marshall – I94 and I69

Hampton Inn, 325 Sam Hill Dr, Marshall  
Holiday Inn Express 329 Sam Hill Dr Marshall  
Howard's Motel 14884 W Michigan Ave, Marshall

### Charlotte

America's Best Value Inn, 828 E Shepherd St, Charlotte

### Lansing

Red Roof Inn Lansing West 7412 W Saginaw Hwy Lansing

## CAMPING

Permitted on site. Dry Camping only. No hookups, no water, no electricity.

### Alternate Camping with Full Hookups

Camp Turkeyville RV Resort, 18935 15 1/2 Mile Rd, Marshall, MI 49068

## EMERGENCY VETERINARIAN

Greater Lansing Veterinary Center  
1290 W Grand River Ave Suite 500, Williamston, MI 48895 517-708-2525

## Entrance to the field, Day parking and Camping



Entrance to the field is an easement under the electric towers. Parking is along the tree line to the south and east. Please keep a drivable lane. Please contact the FTS if you plan on camping.

## PREMIUM LIST

Early entries close on Wednesday, June 26, 2024 at 9:00 PM  
Gate entries close on the day of the event at 12:00 PM



**Basenji Club of America**

[www.basenji.org](http://www.basenji.org)

**Basenji Specialty  
Lure Coursing Trial**  
AKC Member Club

**Friday, June 28, 2024, #2024000701**

**Cowan Farm  
9809 River Rd  
Bellevue, MI**

**Open/Specials/Veteran/Singles Stake Trial Fees**  
**\$20 early entry or \$30 at gate for each entry**  
**\$10 each for Kennel/Breeder**

Make checks payable to "MGA" in US funds. Mail to...  
Jessica Epstein  
984 Merry Ln  
Leslie MI 49251

Do NOT send entries "signature required".

*The Field Trial Secretary cannot accept conditional, unsigned, incomplete or unpaid entries; please check your completed entry carefully. Entries by e-mail will not be accepted.*



**American  
Kennel Club®**

CERTIFICATION Permission has been granted by the American Kennel Club for the holding of this event under the American Kennel Club rules and regulations.

**GINA M. DINARDO, Executive Secretary**

## Basenji Club of America

President - Pat Marshall; Vice President - Julie Hartigan  
Secretary - Janet Ketz; Treasurer - Laura Mae Hesse  
Directors - Jon Curby, Michelle Hogan, Stella Sapios, Julie Jones, Natalie Scherwin,  
Veronica Nagy, Michael Work

### JUDGE & ASSIGNMENTS

John Arvin, New Jersey  
Marni Smith, Ontario

The judges are assigned to all basenjies.  
Stakes will run in order of: Open, Specials, Veteran and Singles.

### FIELD COMMITTEE

Field Trial Chair: Michelle Hogan 20836 Hall Rd PMB 327 Clinton Twp, MI 48038

Email [pandorabasenjis@gmail.com](mailto:pandorabasenjis@gmail.com) Phone: (586) 246-6261

Field Trial Secretary: Jessica Epstein, 984 Merry Ln, Leslie MI 49251

Email: [wolfpine8@gmail.com](mailto:wolfpine8@gmail.com) Phone: 517-749-1115

Lure Operator: Matt Botzau, Denis Seeley, Joe Shoemaker, Echo Prafke-Marson

Additional Members: Lianna Frazer, Kelli Harmon, Suzanne LaCroix

TRIAL HOURS 11:00 AM until completion

ROLL CALL & INSPECTION

Trial Hounds at 12:30 AM.

Early acceptance of hounds may begin ½ hour prior to the times listed above.

### RIBBONS

First Blue, Second Red, Third Yellow, Fourth White, Fifth Pink.  
Best of Breed Purple & Gold Rosette.

Rosettes offered for: High Score DC, Kennel Stake, Breeder Stake, Bench Stake,  
Additional prizes may be offered by the club or friends of the club.

### ELIGIBILITY

Only purebred Basenjis that are one year of age or older and have been registered with The American Kennel Club or an AKC recognized foreign registry or that have been granted an Indefinite Listing Privilege (ILP) may be entered. Breed disqualifications apply.

All dogs run at owners' sole risk. The hosting clubs and property owners, their agents, members, representatives, volunteers, etc. assume no responsibility for any loss, damage, or injury sustained by exhibitors and handlers or to any of their dogs or property and further assumes no responsibility for injury to children or spectators before, during, or after this event.

### TESTS OFFERED

No tests—Junior Courser (JC) or Qualified Courser (QC)—will be offered.

### STAKES OFFERED

**OPEN:** Open only to Basenjies, with no breed disqualifications, that hold an AKC QC certificate OR have run in the Open Stake prior to Jan. 1, 2010, OR have a Senior Courser title OR have an ASFA or CKC field champion title (a copy of this title must be attached to the entry form if the QC requirement is to be waived) OR have an ASFA Hound Certification (a copy of which must be attached to the entry form if the QC requirement is to be waived). Championship points are awarded from this stake. Hounds under disqualification from AKC, ASFA or CKC Field Trials may **NOT** be entered.

**SPECIALS:** Open only to Basenjies that are eligible to enter the Open Stake **and** have earned their AKC Field Championship title. LCX points may be awarded from this stake. Hounds under disqualification from AKC, ASFA or CKC Field Trials may **NOT** be entered.

**VETERAN:** Open only to Basenjies that are eligible to enter either Open or Specials Stake, and are of Veteran age as determined by their Parent Breed Club (6 years for Basenjies). Championship or LCX points may be awarded from this stake. Hounds under disqualification from AKC, ASFA or CKC Field Trials may **NOT** be entered.

**SINGLES:** Open to all Basenjies of eligible breed, including those that are otherwise disqualified from entering the regular stakes (Open, Specials, and Veteran). Hounds entered in the Singles Stake may not also enter a regular stake at the same event. NO championship or LCX points are awarded from this stake.

**BEST IN FIELD (BIF):** Will not be offered.

### NON-REGULAR STAKES OFFERED

**KENNEL STAKE:** For two Basenjies, designated at the time of entry, entered in any of the stakes, owned and kenneled by the same person.

**BREEDER STAKE:** For two Basenjies, designated at the time of entry, entered in any of the stakes. Both Basenjies must have at least one breeder in common. A hound may only be part of any one Kennel and one Breeder stake entry.

**BENCH STAKE:** For Basenjies that have been awarded the AKC Bench Championship by the closing of the entries. The championship status of the winner must be verifiable.

**HIGH SCORING DC:** For AKC FC Basenjies that have been awarded the AKC Bench Championship by the closing date of entries. The championship status of the winner must be verifiable.

NOTE: There is no entry fee for the Bench or Dual Champion Stake awards but the appropriate boxes **MUST BE CHECKED ON YOUR ENTRY FORM.**

## COURSE PLAN

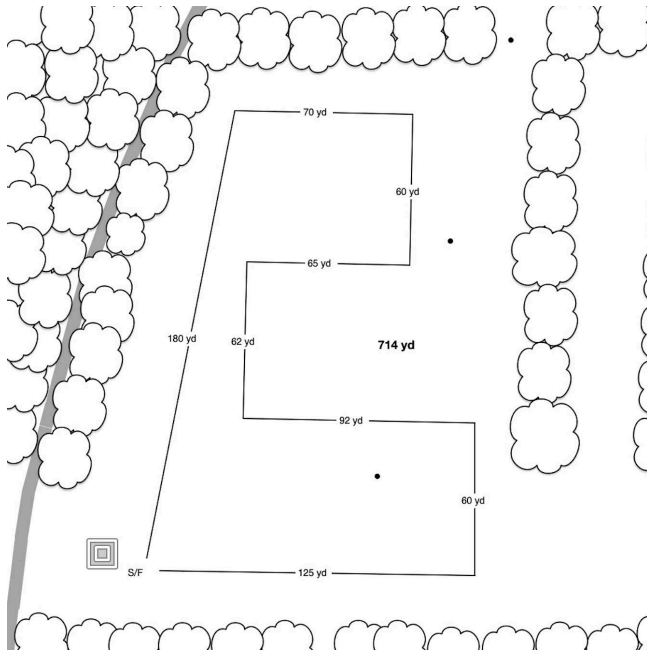

Course will be reversed for finals, run-offs and BOB.

The field committee reserves the right to alter the course due to field and/or weather conditions on the day of the trial.

### NOTICE TO ALL EXHIBITORS

All entries must be one year of age or older on the day of the trial.

Registrations cannot be pending.

Hounds not present at the time of roll call will be scratched after a 5-minute grace period and no refund will be given.

Stakes may be split if sufficient entries are present in any one stake at the time of the draw to support more than one 5-point major.

Bitches in season and lame hounds will be excused. Entries will be refunded. These are the only reasons that pre-entries will be refunded after the pre-entry closing date.

All attempts will be made to separate hounds that have the same owner and live in the same household or being handled by the same person - these entries **MUST** be submitted together to qualify.

There will be a minimum \$25 returned check charge.

Hounds will be checked for breed disqualifications. Spayed and neutered hounds are eligible to participate. Monorchid and cryptorchid hounds are ineligible to participate.

A \$5.00 fine will be assessed for any loose hound on the field that is not competing in the course in progress.

A \$5.00 fine will be assessed for any handler not cleaning up after their hound.

The field is not fenced; adequate shade and cool/drinking water should be provided by the participants.

Gas powered, continuous loop equipment will be used. Lures consist of white or black plastic.

Only the Lure Operator, Huntmaster, Judges and Handlers of the hounds running in the course in progress will be permitted near the lure machine.

Any person may, upon reasonable complaint, be asked to leave the grounds by the Field Committee. Children **MUST** be under control of their parents or guardians at all times.

Three clubs are hosting AKC lure coursing events on this weekend. On Friday, Michigan Gazehound Association is holding all breed JC/QC tests. The American Whippet Club (AWC) is hosting a Whippet specialty lure coursing trial, and the Basenji Club of America (BCOA) is hosting a Basenji specialty lure coursing trial. On Saturday and Sunday, Michigan Gazehound Association is hosting trials and tests. The premium for those events may be found on either [akc.org](http://akc.org) or [michigangazehound.com](http://michigangazehound.com). Instructions and forms for camping are included in the premiums for MGA.

All entries for AWC, BCOA, and MGA must be paid to MGA, either by check or online, as directed in their premiums. All camping fees must be paid separately to MGA and may be submitted with entries to any of one of the 3 clubs.

Instructions on how to Enter and Pay **ONLINE** can be found on the Online Entries Page on the Michigan Gazehound Association website:  
<https://www.michigangazehound.com/online-entries>

If entering for AWC or BCOA, please use the appropriate online entry form. On the payment page, please select either BCOA, or AWC. If entering both MGA and BCOA or AWC, you can submit one form.

### Official American Kennel Club Lure Coursing Entry Form

Club: <b>Basenji Club of America</b>		Date: <b>Fri 28Jun 2024</b>	Event #: <b>2024000701</b>
Location: <b>Cowan Farm, Bellevue,MI</b>		Event type (test or trial): <input type="checkbox"/> Test <input checked="" type="checkbox"/> Trial	
Stakes: <input type="checkbox"/> JC <input type="checkbox"/> CAT <input type="checkbox"/> Special <input type="checkbox"/> FCAT <input type="checkbox"/> OC <input type="checkbox"/> Open <input type="checkbox"/> Veteran	Breed: <b>Basenji</b>	Amount of entry fees enclosed: \$	
Breeder:		AKC No. <input type="checkbox"/> PAL/JLP No. <input type="checkbox"/> Foreign & List Country: <input type="checkbox"/>	Date of Birth:
Call Name:		AKC No:	Sex:
Name of Jr. Handler (if any):		Jr Handler #:	
Full Name of Dog:			
Sire:			
Dam:			
Actual Owner(s):			
Owner's Address:			
City:		State:	Zip:
Name of Owner's Agent/Handler (if any) at Trial:		<input type="checkbox"/> Please Separate My Entries.	
<p>AKC Rules, Regulations, Policies and Guidelines are available on the American Kennel Club website: <a href="http://www.akc.org">www.akc.org</a></p> <p style="text-align: center;"><b>AGREEMENT</b></p> <p>I certify that I am the actual owner of the dog, or that I am the duly authorized agent of the actual owner whose name I have entered above. In consideration of the acceptance of this entry, I (we) agree to abide by the rules and regulations of The American Kennel Club in effect at the time of this event, and any additional rules and regulations appearing in the premium list of this event and entry form and any decision made in accord with them. I (we) agree that the club holding this event has the right to refuse this entry for cause which the club shall deem sufficient. I (we) certify and represent that the dog entered is not a hazard to persons or other dogs. In consideration of the acceptance of this entry and of the holding of this event and of the opportunity to have the dog judged and to win prizes, ribbons, or trophies, I (we) agree to hold the AKC, the event-giving club, their members, directors, governors, all agents, supervisors and event secretary and the owner and/or lessor of the premises and any provider of services that are necessary to hold the event and any employees or volunteers of the aforementioned parties, and any AKC approved judge, judging at this event, harmless from any claim for loss or injury which may be alleged to have been caused directly or indirectly to any person or thing by the act of this dog while in or about the event premises or grounds or near any entrance thereto, and I (we) personally assume all responsibility and liability for any such claim, and I (we) further agree to hold the aforementioned parties harmless from any claim for loss, injury or damage to this dog. Additionally, I (we) hereby assume the sole responsibility for and agree to indemnify, defend and save the aforementioned parties harmless from any and all loss and expense (including legal fees) by reason of the liability imposed by law upon any of the aforementioned parties for damage because of bodily injury, including death at any time resulting therefrom sustained by any person or person, including myself (ourselves), or an account of damage to property, arising out of or in consequence of my (our) participation in this event, however such (injury, death) or property damage may be caused, and whether or not the same may have been caused or may be alleged to have been caused by the negligence of the aforementioned parties or any of their employees, agents, or any other person. I (we) agree that the determination of whether the injury is serious shall be made by the event veterinarian and is binding on me (us). I (WE) AGREE THAT ANY CAUSE OF ACTION, CONTROVERSY OR CLAIM ARISING OUT OF OR RELATED TO THE ENTRY, EXHIBITION OR ATTENDANCE AT THE EVENT BETWEEN THE AKC AND THE EVENT-GIVING CLUB (UNLESS OTHERWISE STATED IN THIS PREMIUM LIST) AND MYSELF (OURSELVES) OR AS TO THE CONSTRUCTION, INTERPRETATION AND EFFECT OF THIS AGREEMENT SHALL BE SETTLED BY ARBITRATION PURSUANT TO THE APPLICABLE RULES OF THE AMERICAN ARBITRATION ASSOCIATION. HOWEVER, PRIOR TO ARBITRATION ALL APPLICABLE AKC BYLAWS, RULES, REGULATIONS AND PROCEDURES MUST FIRST BE FOLLOWED AS SET FORTH IN THE AKC CHARTER AND BYLAWS, RULES, REGULATIONS, PUBLISHED POLICIES AND GUIDELINES.</p>			
Signature of owner or agent duly authorized to make this entry:			
Tel:		Email:	

ALR999 (03/17) v1.1 Edt

### Official American Kennel Club Lure Coursing Entry Form

Club: <b>Basenji Club of America</b>		Date: <b>Fri 28 Jun 2024</b>	Event #: <b>2024000701</b>
Location: <b>Cowan Farm, Bellevue,MI</b>		Event type (test or trial): <input type="checkbox"/> Test <input checked="" type="checkbox"/> Trial	
Stakes: <input type="checkbox"/> JC <input type="checkbox"/> CAT <input type="checkbox"/> Special <input type="checkbox"/> FCAT <input type="checkbox"/> OC <input type="checkbox"/> Open <input type="checkbox"/> Veteran	Breed: <b>Basenji</b>	Amount of entry fees enclosed: \$	
Breeder:		AKC No. <input type="checkbox"/> PAL/JLP No. <input type="checkbox"/> Foreign & List Country: <input type="checkbox"/>	Date of Birth:
Call Name:		AKC No:	Sex:
Name of Jr. Handler (if any):		Jr Handler #:	
Full Name of Dog:			
Sire:			
Dam:			
Actual Owner(s):			
Owner's Address:			
City:		State:	Zip:
Name of Owner's Agent/Handler (if any) at Trial:		<input type="checkbox"/> Please Separate My Entries.	
<p>AKC Rules, Regulations, Policies and Guidelines are available on the American Kennel Club website: <a href="http://www.akc.org">www.akc.org</a></p> <p style="text-align: center;"><b>AGREEMENT</b></p> <p>I certify that I am the actual owner of the dog, or that I am the duly authorized agent of the actual owner whose name I have entered above. In consideration of the acceptance of this entry, I (we) agree to abide by the rules and regulations of The American Kennel Club in effect at the time of this event, and any additional rules and regulations appearing in the premium list of this event and entry form and any decision made in accord with them. I (we) agree that the club holding this event has the right to refuse this entry for cause which the club shall deem sufficient. I (we) certify and represent that the dog entered is not a hazard to persons or other dogs. In consideration of the acceptance of this entry and of the holding of this event and of the opportunity to have the dog judged and to win prizes, ribbons, or trophies, I (we) agree to hold the AKC, the event-giving club, their members, directors, governors, all agents, supervisors and event secretary and the owner and/or lessor of the premises and any provider of services that are necessary to hold the event and any employees or volunteers of the aforementioned parties, and any AKC approved judge, judging at this event, harmless from any claim for loss or injury which may be alleged to have been caused directly or indirectly to any person or thing by the act of this dog while in or about the event premises or grounds or near any entrance thereto, and I (we) personally assume all responsibility and liability for any such claim, and I (we) further agree to hold the aforementioned parties harmless from any claim for loss, injury or damage to this dog. Additionally, I (we) hereby assume the sole responsibility for and agree to indemnify, defend and save the aforementioned parties harmless from any and all loss and expense (including legal fees) by reason of the liability imposed by law upon any of the aforementioned parties for damage because of bodily injury, including death at any time resulting therefrom sustained by any person or person, including myself (ourselves), or an account of damage to property, arising out of or in consequence of my (our) participation in this event, however such (injury, death) or property damage may be caused, and whether or not the same may have been caused or may be alleged to have been caused by the negligence of the aforementioned parties or any of their employees, agents, or any other person. I (we) agree that the determination of whether the injury is serious shall be made by the event veterinarian and is binding on me (us). I (WE) AGREE THAT ANY CAUSE OF ACTION, CONTROVERSY OR CLAIM ARISING OUT OF OR RELATED TO THE ENTRY, EXHIBITION OR ATTENDANCE AT THE EVENT BETWEEN THE AKC AND THE EVENT-GIVING CLUB (UNLESS OTHERWISE STATED IN THIS PREMIUM LIST) AND MYSELF (OURSELVES) OR AS TO THE CONSTRUCTION, INTERPRETATION AND EFFECT OF THIS AGREEMENT SHALL BE SETTLED BY ARBITRATION PURSUANT TO THE APPLICABLE RULES OF THE AMERICAN ARBITRATION ASSOCIATION. HOWEVER, PRIOR TO ARBITRATION ALL APPLICABLE AKC BYLAWS, RULES, REGULATIONS AND PROCEDURES MUST FIRST BE FOLLOWED AS SET FORTH IN THE AKC CHARTER AND BYLAWS, RULES, REGULATIONS, PUBLISHED POLICIES AND GUIDELINES.</p>			
Signature of owner or agent duly authorized to make this entry:			
Tel:		Email:	

ALR999 (03/17) v1.1 Edt